

Floor plans

Ashford Lodge

4-bed



Ashford Lodge

4-bed

Floor plans

Total Construction
3570 sq. ft.

Living Area
594 sq. ft.

Master Bedroom 01
212 sq. ft.

Master Bathroom 01
46 sq. ft.

Bedroom 01
21sq. ft.

Bathroom 01
73 sq. ft.

Office
173 sq. ft.

Powder Room
38 sq. ft.

Total Livable
2863 sq. ft.

Kitchen Area
193 sq. ft.

Master Bedroom 02
212 sq. ft.

Master Bathroom 02
78 sq. ft.

Bedroom 02
21 sq. ft.

Bathroom 02
73 sq. ft.

Laundry
177 sq. ft.

Garage
400 sq. ft.

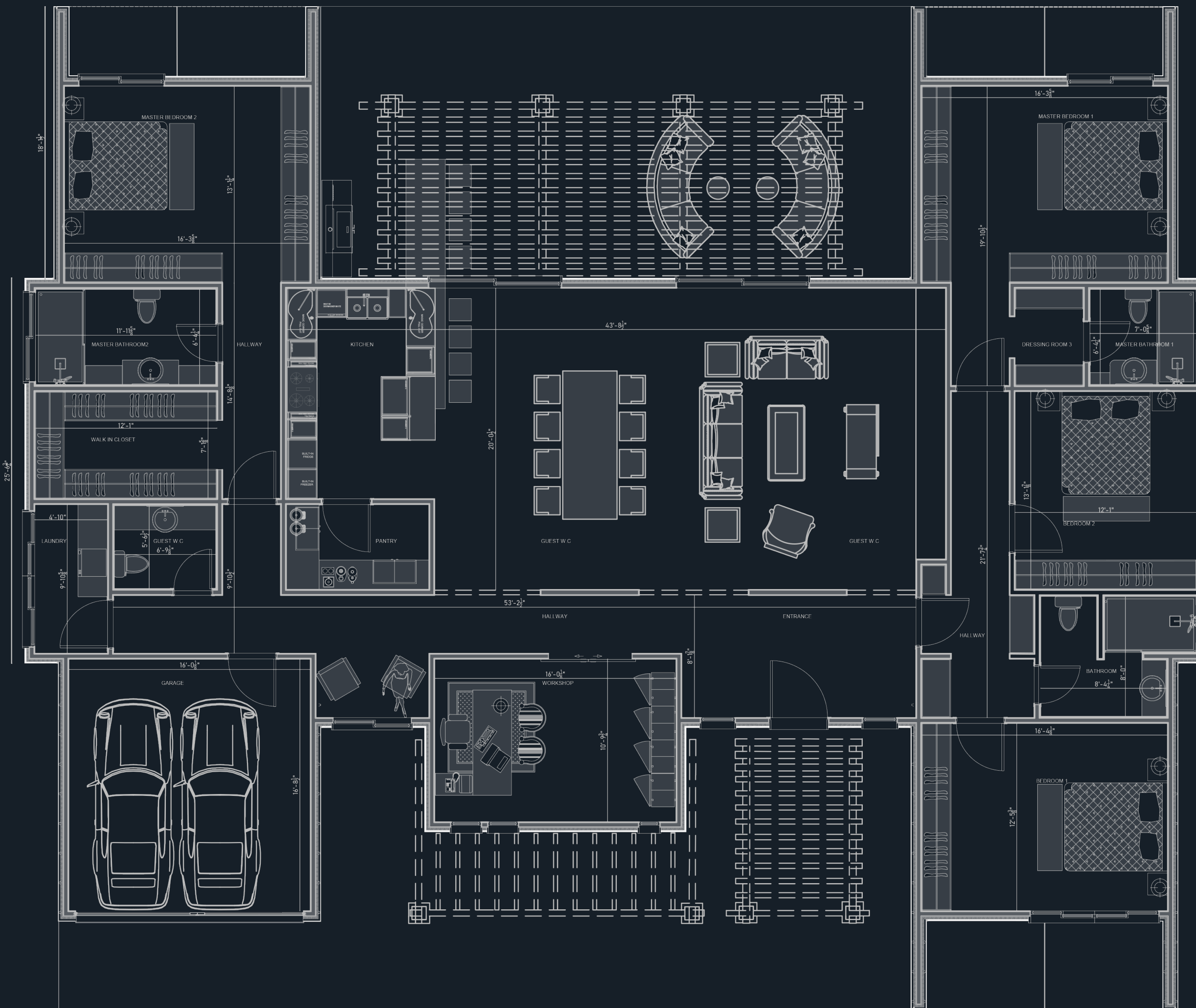

Floor plans

Ashford Lodge

4-bed

@yourhapihome

www.hapihomes.com

