

Floor plans

Bandon

4-bed

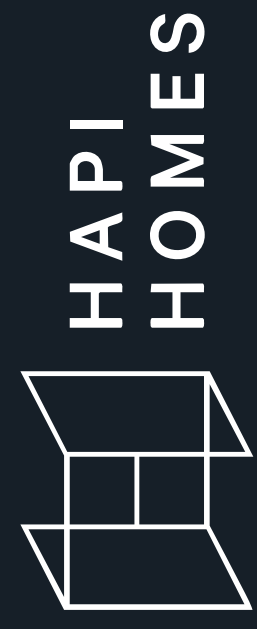

4-bed

Bandon

Floor plans

Total Construction
3955 sq. ft.

First Floor
1385 Sq. ft

Living Area
490 sq. ft.

Dining Area
237 sq. ft.

Powder Room
34 sq. ft.

Garage
348 sq. ft.

Total Livable
3160 sq. ft.

Kitchen Area
180 sq. ft.

Pantry
66 sq. ft.

Laundry Room
13 sq. ft.

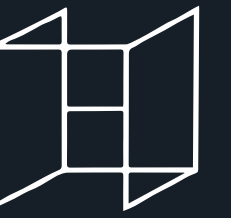

4-bed

Bandon

Floor plans

Second Floor
1775 Sq. ft.

Master Bedroom
331 sq. ft.

Walk In Closet
85 sq. ft.

Bedroom 02
117 sq. ft.

Walk In Closet For Bedroom 3
63 sq. ft.

Office
60 sq. ft.

Balcony
297 sq. ft.

Master Ensuite
84 sq. ft.

Bedroom 01
117 sq. ft.

Bedroom 03
157 sq. ft.

Bathroom
92 sq. ft.

Study
167 sq. ft.

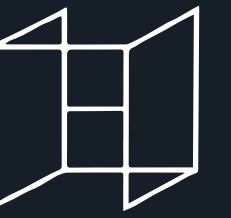

Floor plans

Bandon

4-bed

@yourhapihome

www.hapihomes.com

